

High-Level Line-Interactive UPS

1.1KVA-3KVA

Applications:



Work-Stations



Rack server



Network device



Multiple communication

Professional Line-Interactive UPS Solutions

Eufo series rating is from 1.1kVA to 3.0kVA and implemented protect functions for power failure, surge overvoltage and brownout. Rack/Tower with easy-shift LCD design is flexible for installation. moreover, this series built-in Efficiency corrective Optimizer(ECO) that the efficiency is up to 98% for more energy saving. The application is suitable for networking, telecom, server and mission-critical applications.

GENERAL FEATURES

- Pure sine wave
- Output power factor 0.9
- Microprocessor control optimizes reliability
- User-friendly and easy-shift LCD design
- Rack/Tower 2 in 1 design
- Built-in boost and buck AVR
- Programmable power management outlets
- ECO operation for energy saving (Efficiency Corrective Optimizer)
- Emergency power off function (EPO)
- RJ45 Surge protector
- Hot-swappable battery design
- Built-in internal battery & extend battery function
- Multiple communication available

■ Microprocessor-based line interactive design

Eufo series UPS is designed with microprocessor controller for fast response to power disturbances.

■ Pure sine wave output

With pure sine wave output, Eufo series guarantees compatibility for all kinds of loads. It's perfect power protection for versatile applications such as networking, telecom and other mission-critical applications.

■ User-friendly and easy-shift LCD display

The front panel digital display can be easily shifted through LCD setting to suit the installation format, vertically stand or flat wall mount.

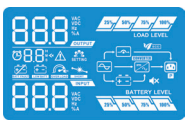

■ Rack / Tower design

Eufo series is designed in true universal-mount case. It can be easily installed as floor-standing tower or in 19-inch rackmount bracket.



19" rack-mounting



Floor-standing Tower

■ Built-in boost and buck AVR

With built-in voltage regulator, the UPS will maintain regulated nominal output without using battery power during brownouts and overvoltages.

■ Output power factor 0.9

Eufo series is a high-density UPS with output power factor 0.9 to provide higher performance and efficiency to critical applications.

■ Programmable power management outlets

With programmable power management outlets, users can easily and independently control load segments. During power failure, this feature enables users to extend battery time to missioncritical devices by shutting down the non-critical devices.

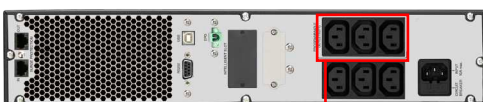

Programmable Outlets (P1)
- connect to non-critical devices

■ ECO operation for energy saving (Efficiency Corrective Optimizer)

The ECO function allows cost-effective operation of UPS Systems as high as 98%. In this operation mode, load is supplied by the mains. When battery is fully charged, the fan will stop running for energy saving. In the event of a mains failure, the inverter takes over the load and provides supply continuity to the connected systems.



■ Emergency Power Off Function (EPO)

This feature can secure the personnel and equipment in case of fires or other emergencies.

■ Hot-swappable battery design

This design ensures clean and uninterruptible power to protected equipment during battery replacement.

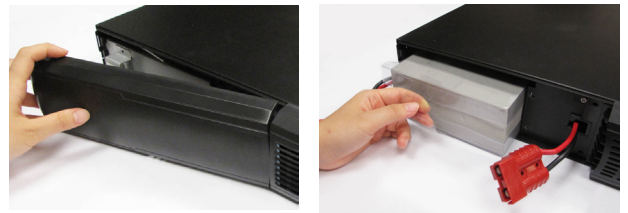

■ Extend battery capacity Function

Eufo series offer extend battery capacity function for long back up time purpose.

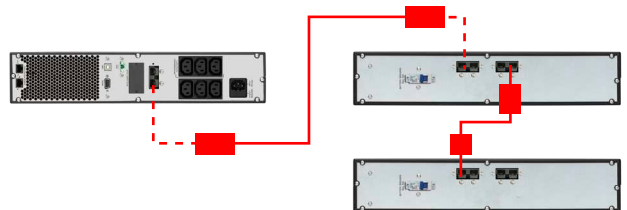

■ RJ-45 Surge protector

Eufo Series implements RJ-45 Surge Protection ports to prevent Ethernet network damage caused by lightning or ground surges.

■ Multiple communication

- USB port
- RS-232 port
- Intelligent slot for SNMP or Relay Card (option)

Also offer free monitoring software, ViewPower, downloaded from the internet. This advanced and networking software supports various operating systems and multiple languages.

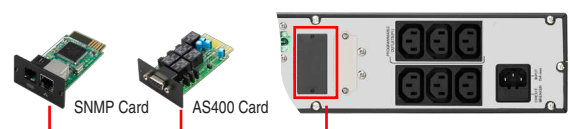

TECHNICAL SPECIFICATIONS

MODEL	20104115	20104116	20104117	
PHASE	Single phase with ground			
CAPACITY	1100 VA / 990 W	2000 VA/ 1800 W	3000 VA/ 2700 W	
INPUT				
Voltage Range	208/220/230/240 VAC			
Acceptable Voltage Range	162-290 VAC			
Frequency Range	50Hz/60Hz (Auto sensing)			
OUTPUT				
Output Voltage	208/220/230/240VAC			
Voltage Regulation	± 1.5% (Before battery Alarm)			
Frequency Range(Batt. Mode)	50 Hz or 60 Hz ± 1 Hz			
Current Crest Ratio	3:1 (max.)			
Harmonic Distortion	2% max @ 100% linear Load ; 5% max @ 100% non linear load (Before low battery alarm)			
Transfer Time	2-6ms (typical), 10ms max.			
Waveform (Batt. Mode)	Pure Sinewave			
EFFICIENCY				
ECO Mode	97%			
Boost/Buck Mode	95%			
Battery Mode	89%	91%	92%	
BATTERY				
Standard Model	Battery Type & Numbers	12 V/9 Ah x 2	12 V/9 Ah x 4	12 V/9 Ah x 6
	Charging Current (max.)	1.5 A		
	Charging Voltage	27.4 VDC ± 1%	54.8 VDC ± 1%	82.1 VDC ± 1%
	Typical Recharge Time	4 hours recover to 90% capacity		
Long-Run Model	Charging Current (max.)	1A/2A/4A/6A/8A		
	Charging Voltage	27.4 VDC ± 1%	54.8 VDC ± 1%	82.1 VDC ± 1%
ALARM				
Battery Mode	Sounding every 10 seconds			
Low Battery	Sounding twice every second			
Overload	Sounding every second			
Fault	Continuously sounding			
AC INPUT & OUTPUT CONNECTORS				
AC Input Connector	1 x IEC 320 C14	1 x IEC 320 C14	1 x IEC 320 C20	
AC Output Connector	8 x IEC 320 C13	8 x IEC 320 C13	6 x IEC 320 C13 / 1 x IEC C19	
STANDARDS				
Safety / EMC	IEC 62040-1 (safety) / IEC-62040-2 (EMC) / CE			
PHYSICAL				
Standard Model	Dimension, D x W x H(mm)	410 (D) x 438 (W) x 88 (H)	510 (D) x 438 (W) x 88 (H)	630 (D) x 438 (W) x 88 (H)
	Net Weight (kgs)	13.4	21.5	29.3
Long-Run Model	Dimension, D x W x H(mm)	410 (D) x 438 (W) x 88 (H)	410 (D) x 438 (W) x 88 (H)	410 (D) x 438 (W) x 88 (H)
	Net Weight (kgs)	9.0	10.8	11.9
ENVIRONMENT				
Operation Humidity	0-90% RH @ 0-40°C (Non-condensing)			
Noise Level	Less than 45 dBA @ 1 Meter			
MANAGEMENT				
Smart RS-232 / USB	Supports Windows 2000/2003/XP/Vista/2008/7/8/10, Linux and MAC			
Optional SNMP	Power management from SNMP manager and web browser			

Product specifications are subject to change without further notice



Backup Time Table for Eufo Series

Model	Battery Bank	Backup Time with Load (Min)			
		25%	50%	75%	100%
20104114	internal battery	22.80	8.65	4.95	3.00
	+ 1 BB-24/18RT (4 x 9Ah Batteries)	76.13	32.79	20.00	13.00
	+ 2 BB-24/18RT (8 x 9Ah Batteries)	134.00	59.28	36.20	25.00
20104115	internal battery	24.50	11.00	5.60	4.00
	+ 1 BB-48/18RT (8 x 9Ah Batteries)	97.00	47.00	27.50	20.00
	+ 2 BB-48/18RT (16 x 9Ah Batteries)	178.00	88.00	53.00	38.00
20104116	internal battery	27.25	11.50	6.60	4.00
	+ 1 BB-72/18RT (12 x 9Ah Batteries)	106.50	46.60	28.37	20.50
	+ 2 BB-72/18RT (24 x 9Ah Batteries)	197.00	86.50	53.05	39.00

